

# NEW STORE DEVELOPMENT



SEE DETAIL A

*AutoZone*

BLDG. AREA = 6816 SF  
PARKING SPACES = 39  
FINISH FLOOR ELEV. = 834

34.20 SW

27E FL=32.16  
RIM=34

5121

5121

NOW OPEN  
AutoZone

GRAN FIESTA DE APERTURA  
GRAN OFERTA DE CLASIFICACION

# AUTOZONE IS THE #1 AUTO PARTS RETAILER IN AMERICA

AutoZone is the leading retailer and a leading distributor of automotive replacement parts and accessories in the United States. We sell auto and light truck parts, chemicals and accessories in over 6,200 AutoZone stores located in 50 states and the District of Columbia in the United States, Puerto Rico and internationally in Mexico and Brazil. All stores are company owned and operated - we do not offer franchises. AutoZone stock is traded on the New York Stock Exchange under the ticker symbol AZO, and is a component of the S&P 500. We are proud to be a Fortune 500 company.

Each AutoZone store carries an extensive product line for cars, sport utility vehicles, vans and light trucks, including new and remanufactured automotive hard parts, maintenance items, accessories, and non-automotive products. Many stores also have a commercial sales program that provides commercial credit and prompt delivery of parts and other products to local, regional and national repair garages, dealers, service stations, and public sector accounts. AutoZone also sells the ALLDATA brand diagnostic and repair software through [www.alldata.com](http://www.alldata.com). Additionally, we sell automotive hard parts, maintenance items, accessories, and non-automotive products through [www.autozone.com](http://www.autozone.com), and our commercial customers can make purchases through [www.autozonepro.com](http://www.autozonepro.com). AutoZone does not derive revenue from automotive repair or installation.

AutoZone always puts customers first, ensuring that over 6 million customers per week continue to select us as their choice for automotive parts and accessories needs. Customers know when they enter an AutoZone store they will always find a great selection of quality merchandise at the low prices they want, as well as the repair information and trustworthy advice they need.

AutoZone strives to be a responsible corporate citizen by giving back to the communities where our AutoZoners and customers live and work. We support education, human services and civic programs across the nation.

## STORE DEVELOPMENT SUPPORT TEAM

### DIRECTOR OF REAL ESTATE

Tahir Sikandar | 901.495.8914 | [tahir.sikandar@autozone.com](mailto:tahir.sikandar@autozone.com)

### REAL ESTATE ZONE MANAGER

Brad Denzin | 901.495.8904 | [brad.denzin@autozone.com](mailto:brad.denzin@autozone.com)

### REAL ESTATE ZONE MANAGER

Kendrick Hickman | 901.495.8921  
[kendrick.hickman@autozone.com](mailto:kendrick.hickman@autozone.com)

### REAL ESTATE ZONE MANAGER

Michael Chastain | 901.495.6872  
[michael.chastain@autozone.com](mailto:michael.chastain@autozone.com)

### DIRECTOR OF RESEARCH

Alex Oliphant | 901.495.8713 | [alex.oliphant@autozone.com](mailto:alex.oliphant@autozone.com)

### DIRECTOR OF PRE-CONSTRUCTION

Troy Taylor | 901.495.8708 | [troy.taylor@autozone.com](mailto:troy.taylor@autozone.com)

### DIRECTOR OF CONSTRUCTION

Dalton Bennett | 901.495.6982 | [dalton.bennett@autozone.com](mailto:dalton.bennett@autozone.com)

### DIRECTOR OF REAL ESTATE ASSET MANAGEMENT

Scott Fraser | 901.495.8788 | [scott.fraser@autozone.com](mailto:scott.fraser@autozone.com)

### MANAGER OF PROPERTY MANAGEMENT

Jan Young, III | 901.495.8817 | [jan.young@autozone.com](mailto:jan.young@autozone.com)

### DUE DILIGENCE MANAGER

Trey Smallwood | 901.495.7956 | [trey.smallwood@autozone.com](mailto:trey.smallwood@autozone.com)

### NATIONAL SIGNAGE MANAGER

Laura Beth Davis | 901.495.7823 | [laura.davis@autozone.com](mailto:laura.davis@autozone.com)

## REAL ESTATE REGIONAL CONTACTS

### U.S.A.

#### ALABAMA

KACEY REED • 901.495.8107  
[kacey.reed@autozone.com](mailto:kacey.reed@autozone.com)

#### ALASKA

BRYAN DAUGHERTY • 901.495.7985  
[bryan.daugherty@autozone.com](mailto:bryan.daugherty@autozone.com)

#### ARIZONA

All except extreme west

LAURA SHARPE • 901.495.8779  
[laura.sharpe@autozone.com](mailto:laura.sharpe@autozone.com)

Extreme West only (Kingman, Bullhead City, Lake Havasu City, Yuma, San Luis)

MICHAEL CHASTAIN • 901.495.6872  
[michael.chastain@autozone.com](mailto:michael.chastain@autozone.com)

#### ARKANSAS

LAURA SHARPE • 901.495.8779  
[laura.sharpe@autozone.com](mailto:laura.sharpe@autozone.com)

#### CALIFORNIA

Following counties only: Butte, Colusa, Del Norte, Glenn, Humboldt, Inyo, Lassen, Los Angeles (all except high desert), Marin, Mendocino, Modoc, Napa, Nevada, Placer, Plumas, Riverside (western portion only: e.g. Riverside), and San Bernardino (all except high desert), Shasta, Sierra, Siskiyou, Sonoma, Sutter, Tehama, Trinity, Yolo, and Yuba

BRYAN DAUGHERTY • 901.495.7985  
[bryan.daugherty@autozone.com](mailto:bryan.daugherty@autozone.com)

Following counties only: Alameda, Alpine, Amador, Calaveras, Contra Costa, El Dorado, Fresno, Imperial, Kern, Kings Lake, Los Angeles (high desert only: e.g. Lancaster/Palmdale), Madera, Mariposa, Merced, Mono, Monterey, Orange, Riverside (eastern portion only: e.g. Palm Springs, Palm Desert, Indio and Blythe), Sacramento, San Benito, San Bernardino (high-desert only: e.g. Twentynine Palms/Hesperia/Victorville/Barstow), San Diego, San Francisco, San Joaquin, San Luis Obispo, San Mateo, Santa Barbara, Santa Clara, Santa Cruz, Solano, Stanislaus, Tulare, and Tuolumne

MICHAEL CHASTAIN • 901.495.6872  
[michael.chastain@autozone.com](mailto:michael.chastain@autozone.com)

#### COLORADO

DAVID NEAL • 901.495.6893  
[david.neal@autozone.com](mailto:david.neal@autozone.com)

#### CONNECTICUT

BILL SMITH • 724.971.4960  
[william.f.smith@autozone.com](mailto:william.f.smith@autozone.com)

#### DELAWARE

JIM HERRING • 901.495.8672  
[james.herring@autozone.com](mailto:james.herring@autozone.com)

#### DISTRICT OF COLUMBIA

LORIE CHAPMAN • 901.495.7507  
[lorie.chapman@autozone.com](mailto:lorie.chapman@autozone.com)

#### FLORIDA

Far Western Panhandle only (Pensacola to Panama City)

KACEY REED • 901.495.8107  
[kacey.reed@autozone.com](mailto:kacey.reed@autozone.com)

North Central, Northern and Eastern Panhandle Portions only (Tallahassee, Jacksonville, Gainesville, and Ocala)

JAMES D. HANCOCK • 901.495.6972  
[james.hancock@autozone.com](mailto:james.hancock@autozone.com)

Central and all south thereof (includes Daytona, Lakeland, Orlando, and Tampa / St. Petersburg, Fort Myers, Fort Lauderdale / Miami metro areas)

BILL SMITH • 724.971.4960  
[william.f.smith@autozone.com](mailto:william.f.smith@autozone.com)

### GEORGIA

Atlanta Metro only

JIM HERRING • 901.495.8672  
[james.herring@autozone.com](mailto:james.herring@autozone.com)

Columbus metro, Bainbridge, Thomasville, as well as all north of Atlanta Metro

KACEY REED • 901.495.8107  
[kacey.reed@autozone.com](mailto:kacey.reed@autozone.com)

South Central and Southeast only (includes Macon, Savannah, Brunswick and Valdosta)

JAMES D. HANCOCK • 901.495.6972  
[james.hancock@autozone.com](mailto:james.hancock@autozone.com)

### HAWAII

MICHAEL CHASTAIN • 901.495.6872  
[michael.chastain@autozone.com](mailto:michael.chastain@autozone.com)

### IDAHO

All except Lewiston and Moscow

DAVID NEAL • 901.495.6893  
[david.neal@autozone.com](mailto:david.neal@autozone.com)

Lewiston and Moscow only

MICHAEL CHASTAIN • 901.495.6872  
[michael.chastain@autozone.com](mailto:michael.chastain@autozone.com)

### ILLINOIS

All north of I-70, but including all of St. Louis metro

JOHNNY MANN • 901.495.8776  
[johnny.mann@autozone.com](mailto:johnny.mann@autozone.com)

Southern portion only (I-70 and south thereof, but excluding St. Louis metro)

STAN CARPENTER • 901.495.8789  
[stan.carpenter@autozone.com](mailto:stan.carpenter@autozone.com)

### INDIANA

Far North only (Gary, South Bend, Elkhart)

JOHNNY MANN • 901.495.8776  
[johnny.mann@autozone.com](mailto:johnny.mann@autozone.com)

All except far North

STAN CARPENTER • 901.495.8789  
[stan.carpenter@autozone.com](mailto:stan.carpenter@autozone.com)

### IOWA

Southeastern portion only (Bettendorf, Davenport, Clinton, Keokuk, Ottumwa, Washington)

JOHNNY MANN • 901.495.8776  
[johnny.mann@autozone.com](mailto:johnny.mann@autozone.com)

All except Southeastern portion

STAN CARPENTER • 901.495.8789  
[stan.carpenter@autozone.com](mailto:stan.carpenter@autozone.com)

### KANSAS

All except extreme South

JOHNNY MANN • 901.495.8776  
[johnny.mann@autozone.com](mailto:johnny.mann@autozone.com)

Extreme South only (Liberal, Arkansas City, Independence, Coffeyville, and Pittsburg)

LAURA SHARPE • 901.495.8779  
[laura.sharpe@autozone.com](mailto:laura.sharpe@autozone.com)

### KENTUCKY

All except extreme South Central and Southeast

STAN CARPENTER • 901.495.8789  
[stan.carpenter@autozone.com](mailto:stan.carpenter@autozone.com)

Extreme South Central and Southeast only (Hopkinsville, Bowling Green, London, Somerset, Corbin, Middlesboro)

KACEY REED • 901.495.8107  
[kacey.reed@autozone.com](mailto:kacey.reed@autozone.com)

# REAL ESTATE REGIONAL CONTACTS (CONT.)

## LOUISIANA

Baton Rouge and New Orleans ADIs only  
**STAN CARPENTER • 901.495.8789**  
stan.carpenter@autozone.com

Alexandria, Monroe, and Shreveport ADIs only  
**LAURA SHARPE • 901.495.8779**  
laura.sharpe@autozone.com

Lafayette and Lake Charles ADIs only  
**TROY DERRICK • 901.495.6059**  
troy.derrick@autozone.com

## MAINE

**BILL SMITH • 724.971.4960**  
william.f.smith@autozone.com

## MARYLAND

All except Eastern Shore  
**LORIE CHAPMAN • 901.495.7507**  
lorie.chapman@autozone.com

Eastern Shore only  
**JIM HERRING • 901.495.8672**  
james.herring@autozone.com

## MASSACHUSETTS

**BILL SMITH • 724.971.4960**  
william.f.smith@autozone.com

## MICHIGAN

All except extreme South  
**JOHNNY MANN • 901.495.8776**  
johnny.mann@autozone.com

Extreme South only (Adrian, Coldwater, Hillsdale, Lambertville, and Monroe)

**JIM HERRING • 901.495.8672**  
james.herring@autozone.com

## MINNESOTA

**STAN CARPENTER • 901.495.8789**  
stan.carpenter@autozone.com

## MISSISSIPPI

Jackson metro and all south thereof  
**STAN CARPENTER • 901.495.8789**  
stan.carpenter@autozone.com

Extreme Northeast (Itawamba and Tishomingo counties only)

**KACEY REED • 901.495.8107**  
kacey.reed@autozone.com

All north of Jackson metro (excludes Itawamba and Tishomingo counties)

**LAURA SHARPE • 901.495.8779**  
laura.sharpe@autozone.com

## MISSOURI

All except South and Southeast (includes St. Louis and Kansas City ADIs)

**JOHNNY MANN • 901.495.8776**  
johnny.mann@autozone.com

Southern and Bootheel areas only (includes Joplin, Springfield, and Kennett)

**LAURA SHARPE • 901.495.8779**  
laura.sharpe@autozone.com

Southeast only (includes Cape Girardeau, Dexter, Jackson, and Poplar Bluff)

**STAN CARPENTER • 901.495.8789**  
stan.carpenter@autozone.com

## MONTANA

**DAVID NEAL • 901.495.6893**  
david.neal@autozone.com

## NEBRASKA

**STAN CARPENTER • 901.495.8789**  
stan.carpenter@autozone.com

## NEVADA

**MICHAEL CHASTAIN • 901.495.6872**  
michael.chastain@autozone.com

## NEW HAMPSHIRE

**BILL SMITH • 724.971.4960**  
william.f.smith@autozone.com

## NEW JERSEY

Ocean county, and all north of I-195 (excepting Mercer county)

**BILL SMITH • 724.971.4960**  
william.f.smith@autozone.com

All North of I-78 (excluding Newark metro)

**JIM HERRING • 901.495.8672**  
james.herring@autozone.com

Trenton metro (all of Mercer County), and all south of I-195 (excepting Ocean county)

**JIM HERRING • 901.495.8672**  
james.herring@autozone.com

## NEW MEXICO

Central and Northern portions only (includes Albuquerque & Santa Fe)

**DAVID NEAL • 901.495.6893**  
david.neal@autozone.com

Southern portions only (includes Roswell & Las Cruces)

**LAURA SHARPE • 901.495.8779**  
laura.sharpe@autozone.com

Clovis and Portales only  
**TROY DERRICK • 901.495.6059**  
troy.derrick@autozone.com

## NEW YORK

New York City metro (includes all boroughs, Long Island, and all South of I-84)

**BILL SMITH • 724.971.4960**  
william.f.smith@autozone.com

All except New York City metro  
**BRIAN WHALEY • 901.495.6642**  
brian.whaley@autozone.com

## NORTH CAROLINA

East Half (includes Burlington, Raleigh-Durham, Fayetteville, Rocky Mount, Greenville, and east coast)

**JAMES D. HANCOCK • 901.495.6972**  
james.hancock@autozone.com

West Half, but excluding extreme Southwest (includes Greensboro, High Point, Winston-Salem, Charlotte, and Asheville)

**JIM HERRING • 901.495.8672**  
james.herring@autozone.com

Extreme Southwest only (Nantahala National Forest and Great Smoky Mountains National Park areas)

**KACEY REED • 901.495.8107**  
kacey.reed@autozone.com

## NORTH DAKOTA

**STAN CARPENTER • 901.495.8789**  
stan.carpenter@autozone.com

## OHIO

Cleveland ADI only  
**BRIAN WHALEY • 901.495.6642**  
brian.whaley@autozone.com

Cincinnati and Columbus ADIs only  
**STAN CARPENTER • 901.495.8789**  
stan.carpenter@autozone.com

## OHIO (CONT.)

Far eastern edge only: (includes Conneaut, Youngstown, Liverpool, Steubenville, Belpre, and Marietta)

**JIM HERRING • 901.495.8672**  
james.herring@autozone.com

## OKLAHOMA

All except extreme Southeast

**LAURA SHARPE • 901.495.8779**  
laura.sharpe@autozone.com

Extreme Southeast only (Durant, Hugo, and Idabel)  
**TROY DERRICK • 901.495.6059**  
troy.derrick@autozone.com

## OREGON

**BRYAN DAUGHERTY • 901.495.7985**  
bryan.daugherty@autozone.com

## PENNSYLVANIA

Pittsburgh and Philadelphia ADIs, and extreme Northwest (Sharon/Meadville/Erie)

**JIM HERRING • 901.495.8672**  
james.herring@autozone.com

South Central (South of I-80 between I-99 and I-83; includes State College, Harrisburg, and York)

**LORIE CHAPMAN • 901.495.7507**  
lorie.chapman@autozone.com

I-80 corridor east of I-79, and all north thereof, as well as Southeastern portion (includes Allentown, Lancaster, and Reading, but excludes Philadelphia metro)

**BRIAN WHALEY • 901.495.6642**  
brian.whaley@autozone.com

## RHODE ISLAND

**BILL SMITH • 724.971.4960**  
william.f.smith@autozone.com

## SOUTH CAROLINA

**JAMES D. HANCOCK • 901.495.6972**  
james.hancock@autozone.com

## SOUTH DAKOTA

West Half (includes Rapid City and Spearfish)

**DAVID NEAL • 901.495.6893**  
david.neal@autozone.com

East Half (includes Sioux Falls, Mitchell and Yankton)

**STAN CARPENTER • 901.495.8789**  
stan.carpenter@autozone.com

## TENNESSEE

Memphis ADI only

**LAURA SHARPE • 901.495.8779**  
laura.sharpe@autozone.com

Tri-Cities metro area only

**JIM HERRING • 901.495.8672**  
james.herring@autozone.com

All except Memphis ADI and Tri-cities metro (includes Jackson, Nashville, Knoxville, and Chattanooga ADIs)

**KACEY REED • 901.495.8107**  
kacey.reed@autozone.com

## TEXAS

Wichita Falls Metro, and Extreme West (Midland/Odessa to El Paso)

**LAURA SHARPE • 901.495.8779**  
laura.sharpe@autozone.com

Mid-state (Abilene, Austin, Killeen, Lubbock, San Angelo, San Antonio, and Waco) and Rio Grande Valley

**KACEY REED • 901.495.8107**  
kacey.reed@autozone.com

DFW, Houston, Corpus Christi and Amarillo metro areas  
**TROY DERRICK • 901.495.6059**  
troy.derrick@autozone.com

## UTAH

All except extreme Southwest

**DAVID NEAL • 901.495.6893**  
david.neal@autozone.com

Extreme Southwest only (Cedar City to St. George)

**MICHAEL CHASTAIN • 901.495.6872**  
michael.chastain@autozone.com

## VERMONT

**BRIAN WHALEY • 901.495.6642**  
brian.whaley@autozone.com

## VIRGINIA

All except extreme Southwest and South Central, but excluding all of East of Chesapeake Bay

**LORIE CHAPMAN • 901.495.7507**  
lorie.chapman@autozone.com

Extreme Southwest and South Central only (Bristol, Danville, South Boston and Wise)

**JAMES D. HANCOCK • 901.495.6972**  
james.hancock@autozone.com

East of Chesapeake Bay only

**JIM HERRING • 901.495.8672**  
james.herring@autozone.com

## WASHINGTON

Vancouver Metro only (Battle Ground, Vancouver, and Washougal)

**BRYAN DAUGHERTY • 901.495.7985**  
bryan.daugherty@autozone.com

All except Vancouver metro

**MICHAEL CHASTAIN • 901.495.6872**  
michael.chastain@autozone.com

## WEST VIRGINIA

Far South (Beckley, Bluefield, Princeton) and far Northeast (Keyser, Martinsburg, Charles Town)

**LORIE CHAPMAN • 901.495.7507**  
lorie.chapman@autozone.com

North Central (includes Parkersburg, Fairmont, Morgantown, and Wheeling)

**JIM HERRING • 901.495.8672**  
james.herring@autozone.com

Charleston, Huntington, and Logan only  
**STAN CARPENTER • 901.495.8789**  
stan.carpenter@autozone.com

## WISCONSIN

**JOHNNY MANN • 901.495.8776**  
johnny.mann@autozone.com

## WYOMING

**DAVID NEAL • 901.495.6893**  
david.neal@autozone.com



## PUERTO RICO

**BRAD DENZIN • 901.495.8904**  
brad.denzin@autozone.com



## BRAZIL

**PAULO FERREIRA**  
+55 (11) 3279.5311 (São Paulo, Brazil)  
paulo.ferreira@autozone.com



## MEXICO

**PAVEL CARRILLO**  
+52 (81) 8155.7339  
pavel.carrillo@autozone.com



## U.S. VIRGIN ISLANDS

**BRAD DENZIN • 901.495.8904**  
brad.denzin@autozone.com

# PROTOTYPICAL SITE PLAN EXAMPLES



- + Stores typically range from 6,500 square feet to 8,000 square feet
- + Must accommodate between 25 and 40 uncongested, customer-friendly parking spaces
- + We require up-front, high-impact locations with excellent visibility and access from adjacent streets

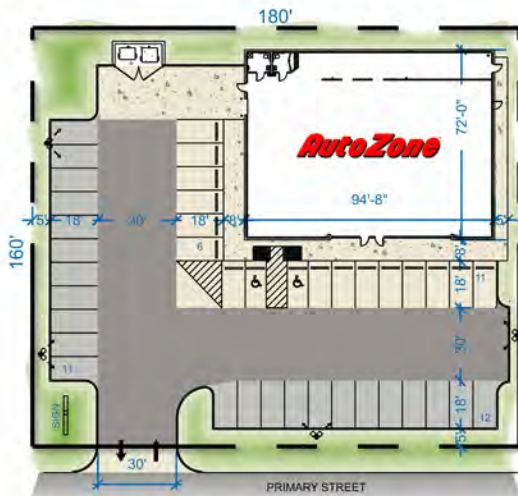

**65W2 Left**

Net: 6,323 SF  
Gross: 6,816 SF

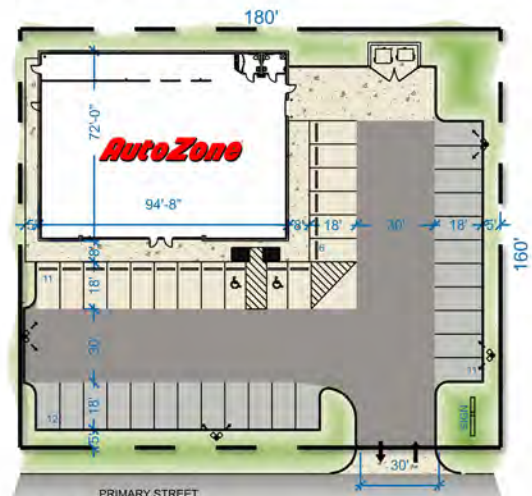

**65W2 Right**

Net: 6,323 SF  
Gross: 6,816 SF



**7N2 Left**

Net: 6,905 SF  
Gross: 7,381 SF

- REGULAR DUTY ASPHALT
- HEAVY DUTY ASPHALT
- REGULAR DUTY CONCRETE
- HEAVY DUTY CONCRETE



**7N2 Right**

Net: 6,905 SF  
Gross: 7,381 SF

## VISIT US ON THE INTERNET

For new store development:  
[www.autozonerealestate.com](http://www.autozonerealestate.com)



For surplus properties:  
[www.autozoneexcessproperty.com](http://www.autozoneexcessproperty.com)

