

# NEW STORE DEVELOPMENT

# AutoZone



# AUTOZONE IS THE #1 AUTO PARTS RETAILER IN AMERICA

AutoZone is the leading retailer and a leading distributor of automotive replacement parts and accessories in the Americas. We sell auto and light truck parts, chemicals and accessories in over 6,400 AutoZone stores located in 50 states and the District of Columbia in the United States, Puerto Rico, Saint Thomas U.S. Virgin Islands, Mexico and Brazil. All stores are company owned and operated - we do not offer franchises. AutoZone stock is traded on the New York Stock Exchange under the ticker symbol AZO, and is a component of the S&P 500. We are proud to be a Fortune 500 company.

Each AutoZone store carries an extensive product line for cars, sport utility vehicles, vans and light trucks, including new and remanufactured automotive hard parts, maintenance items, accessories, and non-automotive products. Many stores also have a commercial sales program that provides commercial credit and prompt delivery of parts and other products to local, regional and national repair garages, dealers, service stations, and public sector accounts. AutoZone also sells the ALLDATA brand diagnostic and repair software through [www.alldata.com](http://www.alldata.com). Additionally, we sell automotive hard parts, maintenance items, accessories, and non-automotive products through [www.autozone.com](http://www.autozone.com), and our commercial customers can make purchases through [www.autozonepro.com](http://www.autozonepro.com). AutoZone does not derive revenue from automotive repair or installation.

AutoZone always puts customers first, ensuring that over 6 million customers per week continue to select us as their choice for automotive parts and accessories needs. Customers know when they enter an AutoZone store they will always find a great selection of quality merchandise at the low prices they want, as well as the repair information and trustworthy advice they need.

AutoZone strives to be a responsible corporate citizen by giving back to the communities where our AutoZoners and customers live and work. We support education, human services and civic programs across the nation.

## STORE DEVELOPMENT SUPPORT TEAM

### DIRECTOR OF REAL ESTATE

Tahir Sikandar | 901.495.8914 | [tahir.sikandar@autozone.com](mailto:tahir.sikandar@autozone.com)

### REAL ESTATE ZONE MANAGER

Brad Denzin | 901.495.8904 | [brad.denzin@autozone.com](mailto:brad.denzin@autozone.com)

### REAL ESTATE ZONE MANAGER

Kendrick Hickman | 901.495.8921  
[kendrick.hickman@autozone.com](mailto:kendrick.hickman@autozone.com)

### REAL ESTATE ZONE MANAGER

Michael Chastain | 901.495.6872  
[michael.chastain@autozone.com](mailto:michael.chastain@autozone.com)

### DIRECTOR OF RESEARCH

Alex Oliphant | 901.495.8713 | [alex.oliphant@autozone.com](mailto:alex.oliphant@autozone.com)

### DIRECTOR OF PRE-CONSTRUCTION

Troy Taylor | 901.495.8708 | [troy.taylor@autozone.com](mailto:troy.taylor@autozone.com)

### DIRECTOR OF CONSTRUCTION

Dalton Bennett | 901.495.6982 | [dalton.bennett@autozone.com](mailto:dalton.bennett@autozone.com)

### SENIOR REAL ESTATE ASSET MANAGER

Jeff McClanahan | 901.495.8974 | [jeff.mcclanahan@autozone.com](mailto:jeff.mcclanahan@autozone.com)

### MANAGER OF PROPERTY MANAGEMENT

Jan Young, III | 901.495.8817 | [jan.young@autozone.com](mailto:jan.young@autozone.com)

### DUE DILIGENCE PROCUREMENT MANAGER

Brian Siddall | 901.495.7996 | [brian.siddall@autozone.com](mailto:brian.siddall@autozone.com)

### NATIONAL SIGNAGE MANAGER

Laura Beth Davis | 901.495.7823 | [laura.davis@autozone.com](mailto:laura.davis@autozone.com)

## REAL ESTATE REGIONAL CONTACTS

### U.S.A.

#### ALABAMA

KACEY REED • 901.495.8107

[kacey.reed@autozone.com](mailto:kacey.reed@autozone.com)

#### ALASKA

BRYAN DAUGHERTY • 901.495.7985

[bryan.daugherty@autozone.com](mailto:bryan.daugherty@autozone.com)

#### ARIZONA

All except extreme west

LAURA SHARPE • 901.495.8779

[laura.sharpe@autozone.com](mailto:laura.sharpe@autozone.com)

Extreme West only (Kingman, Bullhead City, Lake Havasu City, Yuma, San Luis)

SCOTT ARMSTRONG • 901.495.7320

[scott.armstrong@autozone.com](mailto:scott.armstrong@autozone.com)

#### ARKANSAS

LAURA SHARPE • 901.495.8779

[laura.sharpe@autozone.com](mailto:laura.sharpe@autozone.com)

#### CALIFORNIA

Following counties only: Butte, Colusa, Del Norte, Glenn, Humboldt, Inyo, Lassen, Los Angeles (all except high desert), Marin, Mendocino, Modoc, Napa, Nevada, Placer, Plumas, Riverside (western portion only: e.g. Riverside), and San Bernardino (all except high desert), Shasta, Sierra, Siskiyou, Sonoma, Sutter, Tehama, Trinity, Yolo, and Yuba

BRYAN DAUGHERTY • 901.495.7985

[bryan.daugherty@autozone.com](mailto:bryan.daugherty@autozone.com)

Following counties only: Alameda, Alpine, Amador, Calaveras, Contra Costa, El Dorado, Fresno, Imperial, Kern, Kings Lake, Los Angeles (high desert only: e.g. Lancaster/Palmdale), Madera, Mariposa, Merced, Mono, Monterey, Orange, Riverside (eastern portion only; e.g. Palm Springs, Palm Desert, Indio and Blythe), Sacramento, San Benito, San Bernardino (high-desert only: e.g. Twentynine Palms/Hesperia/Victorville/Barstow), San Diego, San Francisco, San Joaquin, San Luis Obispo, San Mateo, Santa Barbara, Santa Clara, Santa Cruz, Solano, Stanislaus, Tulare, and Tuolumne

ANDREW MCLEAN • 901.495.6576

[andrew.mclean@autozone.com](mailto:andrew.mclean@autozone.com)

#### COLORADO

DAVID NEAL • 901.495.6893

[david.neal@autozone.com](mailto:david.neal@autozone.com)

#### CONNECTICUT

BILL SMITH • 724.971.4960

[william.f.smith@autozone.com](mailto:william.f.smith@autozone.com)

#### DELAWARE

JIM HERRING • 901.495.8672

[james.herring@autozone.com](mailto:james.herring@autozone.com)

#### DISTRICT OF COLUMBIA

LORIE CHAPMAN • 901.495.7507

[lorie.chapman@autozone.com](mailto:lorie.chapman@autozone.com)

#### FLORIDA

Far Western Panhandle only (Pensacola to Panama City)

KACEY REED • 901.495.8107

[kacey.reed@autozone.com](mailto:kacey.reed@autozone.com)

North Central, Northern and Eastern Panhandle Portions only (Tallahassee, Jacksonville, Gainesville, and Ocala)

KACEY REED • 901.495.8107

[kacey.reed@autozone.com](mailto:kacey.reed@autozone.com)

Central and Central East Coast only (Orlando metro, and the east coast from Daytona Beach south to Jupiter)

BILL SMITH • 724.971.4960

[william.f.smith@autozone.com](mailto:william.f.smith@autozone.com)

#### FLORIDA (CONT.)

Tampa/St. Pete/Lakeland, Fort Myers, Naples, Sarasota, Fort Lauderdale / Miami metro area, and Palm Beach county south of Jupiter

SCOTT ARMSTRONG • 901.495.7320

[scott.armstrong@autozone.com](mailto:scott.armstrong@autozone.com)

#### GEORGIA

Augusta ADI only

BRYAN DAUGHERTY • 901.495.7985

[bryan.daugherty@autozone.com](mailto:bryan.daugherty@autozone.com)

Atlanta Metro only

JIM HERRING • 901.495.8672

[james.herring@autozone.com](mailto:james.herring@autozone.com)

All except Augusta ADI and Atlanta Metro

KACEY REED • 901.495.8107

[kacey.reed@autozone.com](mailto:kacey.reed@autozone.com)

#### HAWAII

MICHAEL CHASTAIN • 901.495.6872

[michael.chastain@autozone.com](mailto:michael.chastain@autozone.com)

#### IDAHO

Lewiston and Moscow only

SCOTT ARMSTRONG • 901.495.7320

[scott.armstrong@autozone.com](mailto:scott.armstrong@autozone.com)

All except Lewiston and Moscow

DAVID NEAL • 901.495.6893

[david.neal@autozone.com](mailto:david.neal@autozone.com)

#### ILLINOIS

Southern portion only (I-70 and south thereof, but excluding St. Louis metro)

STAN CARPENTER • 901.495.8789

[stan.carpenter@autozone.com](mailto:stan.carpenter@autozone.com)

All north of I-70, but including all of

St. Louis metro

JOHNNY MANN • 901.495.8776

[johnny.mann@autozone.com](mailto:johnny.mann@autozone.com)

#### INDIANA

All except far North

STAN CARPENTER • 901.495.8789

[stan.carpenter@autozone.com](mailto:stan.carpenter@autozone.com)

Far North only (Gary, South Bend, Elkhart)

JOHNNY MANN • 901.495.8776

[johnny.mann@autozone.com](mailto:johnny.mann@autozone.com)

#### IOWA

All except Southeastern portion

STAN CARPENTER • 901.495.8789

[stan.carpenter@autozone.com](mailto:stan.carpenter@autozone.com)

Southeastern portion only (Bettendorf, Davenport, Clinton, Keokuk, Ottumwa, Washington)

JOHNNY MANN • 901.495.8776

[johnny.mann@autozone.com](mailto:johnny.mann@autozone.com)

#### KANSAS

All except extreme South

JOHNNY MANN • 901.495.8776

[johnny.mann@autozone.com](mailto:johnny.mann@autozone.com)

Extreme South only (Liberal, Arkansas City, Independence, Coffeyville, and Pittsburg)

LAURA SHARPE • 901.495.8779

[laura.sharpe@autozone.com](mailto:laura.sharpe@autozone.com)

#### KENTUCKY

All except extreme South Central and Southeast

STAN CARPENTER • 901.495.8789

[stan.carpenter@autozone.com](mailto:stan.carpenter@autozone.com)

Extreme South Central and Southeast only (Hopkinsville, Bowling Green, London, Somerset, Corbin, Middlesboro)

KACEY REED • 901.495.8107

[kacey.reed@autozone.com](mailto:kacey.reed@autozone.com)

# REAL ESTATE REGIONAL CONTACTS (CONT.)

## LOUISIANA

B Lafayette and Lake Charles ADIs only

**FRANK BAEZA • 832.715.5160**  
frank.baeza@autozone.com

Baton Rouge and New Orleans ADIs only

**STAN CARPENTER • 901.495.8789**  
stan.carpenter@autozone.com

Alexandria, Monroe, and Shreveport ADIs only

**LAURA SHARPE • 901.495.8779**  
laura.sharpe@autozone.com

## MAINE

**BILL SMITH • 724.971.4960**  
william.f.smith@autozone.com

## MARYLAND

All except Eastern Shore

**LORIE CHAPMAN • 901.495.7507**  
lorie.chapman@autozone.com

Eastern Shore only

**JIM HERRING • 901.495.8672**  
james.herring@autozone.com

## MASSACHUSETTS

**BILL SMITH • 724.971.4960**  
william.f.smith@autozone.com

## MICHIGAN

Extreme South only (Adrian, Coldwater, Hillsdale, Lambertville, and Monroe)

**JIM HERRING • 901.495.8672**  
james.herring@autozone.com

All except extreme South

**JOHNNY MANN • 901.495.8776**  
johnny.mann@autozone.com

## MINNESOTA

**STAN CARPENTER • 901.495.8789**  
stan.carpenter@autozone.com

## MISSISSIPPI

Jackson metro and all south thereof

**STAN CARPENTER • 901.495.8789**  
stan.carpenter@autozone.com

Extreme Northeast (Itawamba and Tishomingo counties only)

**KACEY REED • 901.495.8107**  
kacey.reed@autozone.com

All north of Jackson metro (excludes Itawamba and Tishomingo counties)

**LAURA SHARPE • 901.495.8779**  
laura.sharpe@autozone.com

## MISSOURI

Southeast only (includes Cape Girardeau, Dexter, Jackson, and Poplar Bluff)

**STAN CARPENTER • 901.495.8789**  
stan.carpenter@autozone.com

All except South and Southeast (includes St. Louis and Kansas City ADIs)

**JOHNNY MANN • 901.495.8776**  
johnny.mann@autozone.com

Southern and Bootheel areas only (includes Joplin, Springfield, and Kennett)

**LAURA SHARPE • 901.495.8779**  
laura.sharpe@autozone.com

## MONTANA

**DAVID NEAL • 901.495.6893**  
david.neal@autozone.com

## NEBRASKA

All except Panhandle

**STAN CARPENTER • 901.495.8789**  
stan.carpenter@autozone.com

Panhandle only

**DAVID NEAL • 901.495.6893**  
david.neal@autozone.com

## NEVADA

Southern portion only (Las Vegas Metro, Pahrump, Mesquite)

**SCOTT ARMSTRONG • 901.495.7320**  
scott.armstrong@autozone.com

Northwest only (Reno, Carson City, Winnemucca)

**ANDREW MCLEAN • 901.495.6576**  
andrew.mclean@autozone.com

Northeast only (Elko, Ely)

**DAVID NEAL • 901.495.6893**  
david.neal@autozone.com

## NEW HAMPSHIRE

**BILL SMITH • 724.971.4960**  
william.f.smith@autozone.com

## NEW JERSEY

All North of I-78 (excluding Newark metro)

**JIM HERRING • 901.495.8672**  
james.herring@autozone.com

Trenton metro (all of Mercer County), and all south of I-195 (excepting Ocean county)

**JIM HERRING • 901.495.8672**  
james.herring@autozone.com

Ocean county, and all north of I-195 (excepting Mercer county)

**BILL SMITH • 724.971.4960**  
william.f.smith@autozone.com

## NEW MEXICO

Central and Northern portions only (includes Albuquerque, Santa Fe, and Clovis)

**DAVID NEAL • 901.495.6893**  
david.neal@autozone.com

Southern portions only (includes Roswell & Las Cruces)

**LAURA SHARPE • 901.495.8779**  
laura.sharpe@autozone.com

## NEW YORK

All except New York City metro

**TROY DERRICK • 901.495.6059**  
troy.derrick@autozone.com

New York City metro (includes all boroughs, Long Island, and all South of I-84)

**BILL SMITH • 724.971.4960**  
william.f.smith@autozone.com

## NORTH CAROLINA

All west of (but excluding) Hickory. Includes Nantahala National Forest, Great Smoky Mountains National Park, Asheville, and Morganton

**LORIE CHAPMAN • 901.495.7507**  
lorie.chapman@autozone.com

Mid-State (Charlotte, Statesville, High Point, Winston-Salem, and Greensboro)

**JIM HERRING • 901.495.8672**  
james.herring@autozone.com

East Half (includes Burlington, Raleigh-Durham, Fayetteville, Rocky Mount, Greenville, and east coast)

**DAVID NEAL • 901.495.6893**  
david.neal@autozone.com

## NORTH DAKOTA

**STAN CARPENTER • 901.495.8789**  
stan.carpenter@autozone.com

## OHIO

Cincinnati, Columbus, and Dayton/Springfield ADIs only

**STAN CARPENTER • 901.495.8789**  
stan.carpenter@autozone.com

All except Cincinnati, Columbus, and Dayton/Springfield ADIs (includes Akron, Cleveland, Toledo, and Youngstown)

**TROY DERRICK • 901.495.6059**  
troy.derrick@autozone.com

## OKLAHOMA

Extreme Southeast only (Durant, Hugo, and Idabel)

**FRANK BAEZA • 832.715.5160**  
frank.baeza@autozone.com

All except extreme Southeast

**LAURA SHARPE • 901.495.8779**  
laura.sharpe@autozone.com

## OREGON

**BRYAN DAUGHERTY • 901.495.7985**  
bryan.daugherty@autozone.com

## PENNSYLVANIA

South Central (South of State College between I-99 and I-83; includes Harrisburg and York)

**LORIE CHAPMAN • 901.495.7507**  
lorie.chapman@autozone.com

I-80 corridor east of I-79, and all north thereof, as well as Southeastern portion (includes Allentown, Lancaster, and Reading, but excludes Philadelphia metro)

**TROY DERRICK • 901.495.6059**  
troy.derrick@autozone.com

Pittsburgh and Philadelphia ADIs, and extreme Northwest (Sharon/Meadville/Erie)

**JIM HERRING • 901.495.8672**  
james.herring@autozone.com

## RHODE ISLAND

**BILL SMITH • 724.971.4960**  
william.f.smith@autozone.com

## SOUTH CAROLINA

Greenville/Greenwood/Anderson/Clemson only

**LORIE CHAPMAN • 901.495.7507**  
lorie.chapman@autozone.com

All except Spartanburg/Greenville/Greenwood/Anderson/Clemson

**BRYAN DAUGHERTY • 901.495.7985**  
bryan.daugherty@autozone.com

Spartanburg only

**JIM HERRING • 901.495.8672**  
james.herring@autozone.com

## SOUTH DAKOTA

East Half (includes Sioux Falls, Mitchell and Yankton)

**STAN CARPENTER • 901.495.8789**  
stan.carpenter@autozone.com

West Half (includes Rapid City and Spearfish)

**DAVID NEAL • 901.495.6893**  
david.neal@autozone.com

## TENNESSEE

Northwest only (Knoxville and Tri-Cities ADIs)

**LORIE CHAPMAN • 901.495.7507**  
lorie.chapman@autozone.com

Jackson, Nashville, and Chattanooga ADIs only

**KACEY REED • 901.495.8107**  
kacey.reed@autozone.com

Memphis ADI only

**LAURA SHARPE • 901.495.8779**  
laura.sharpe@autozone.com

## TEXAS

DFW, Houston, and Corpus Christi metro areas

**FRANK BAEZA • 832.715.5160**  
frank.baeza@autozone.com

Amarillo and Lubbock metro areas only

**DAVID NEAL • 901.495.6893**  
david.neal@autozone.com

Mid-state (Abilene, Austin, Killeen, Lubbock, San Angelo, and Waco), and the Valley (San Antonio and the Rio Grande Valley)

**KACEY REED • 901.495.8107**  
kacey.reed@autozone.com

Wichita Falls Metro, and Extreme West (Midland/Odessa to El Paso)

**LAURA SHARPE • 901.495.8779**  
laura.sharpe@autozone.com

## UTAH

Extreme Southwest only (Cedar City to St. George)

**SCOTT ARMSTRONG • 901.495.7320**  
scott.armstrong@autozone.com

All except extreme Southwest

**DAVID NEAL • 901.495.6893**  
david.neal@autozone.com

## VERMONT

**TROY DERRICK • 901.495.6059**  
troy.derrick@autozone.com

## VIRGINIA

All except South Central (Danville and South Boston) and east of Chesapeake Bay

**LORIE CHAPMAN • 901.495.7507**  
lorie.chapman@autozone.com

East of Chesapeake Bay only

**JIM HERRING • 901.495.8672**  
james.herring@autozone.com

South Central (Danville and South Boston only)

**DAVID NEAL • 901.495.6893**  
david.neal@autozone.com

## WASHINGTON

All east of the Cascades (Spokane, Richland, Kennewick, Walla Walla, and Yakima)

**SCOTT ARMSTRONG • 901.495.7320**  
scott.armstrong@autozone.com

Vancouver Metro only (Battle Ground, Vancouver, and Washougal)

**BRYAN DAUGHERTY • 901.495.7985**  
bryan.daugherty@autozone.com

All west of the Cascades, except Vancouver metro (Sea-Tac, Everett, Bellingham, Olympia)

**ANDREW MCLEAN • 901.495.6576**  
andrew.mclean@autozone.com

## WEST VIRGINIA

Charleston, Huntington, and Logan only

**STAN CARPENTER • 901.495.8789**  
stan.carpenter@autozone.com

Far South (Beckley, Bluefield, Princeton) and far Northeast (Keyser, Martinsburg, Charles Town)

**LORIE CHAPMAN • 901.495.7507**  
lorie.chapman@autozone.com

North Central (includes Parkersburg, Fairmont, Morgantown, and Wheeling)

**JIM HERRING • 901.495.8672**  
james.herring@autozone.com

## WISCONSIN

**JOHNNY MANN • 901.495.8776**  
johnny.mann@autozone.com

## WYOMING

**DAVID NEAL • 901.495.6893**  
david.neal@autozone.com

## PUERTO RICO

**BRAD DENZIN • 901.495.8904**  
brad.denzin@autozone.com

## BRAZIL

**PAULO FERREIRA**  
+55 (11) 3279.5311 (São Paulo, Brazil)  
paulo.ferreira@autozone.com

## MEXICO

**ANICETO MARTINEZ**  
664.375.8028  
aniceto.martinez@autozone.com

## U.S. VIRGIN ISLANDS

**BRAD DENZIN • 901.495.8904**  
brad.denzin@autozone.com

# PROTOTYPICAL SITE PLAN EXAMPLES



- + Stores typically range from 6,500 square feet to 8,000 square feet
- + Must accommodate between 25 and 40 uncongested, customer-friendly parking spaces
- + We require up-front, high-impact locations with excellent visibility and access from adjacent streets

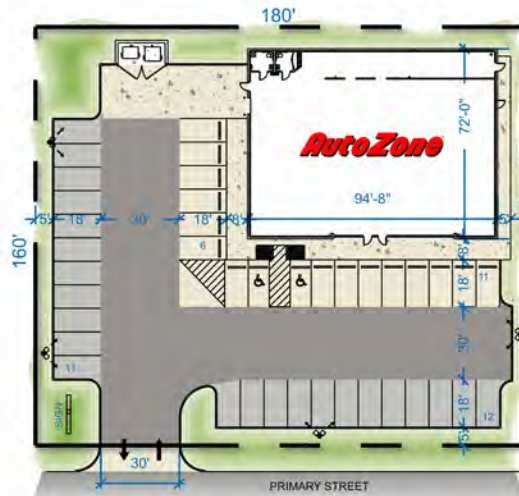

**65W2 Left**

Net: 6,323 SF  
Gross: 6,816 SF

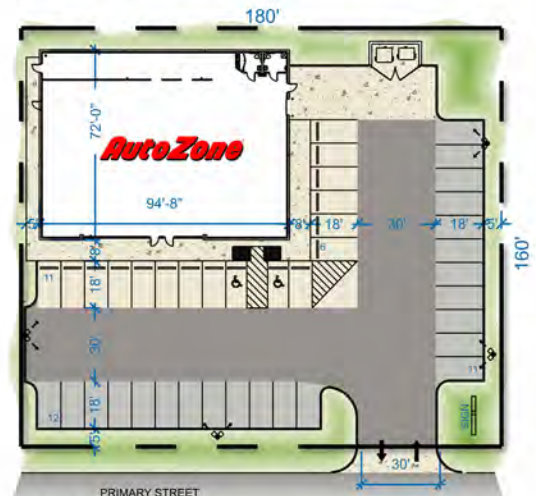

**65W2 Right**

Net: 6,323 SF  
Gross: 6,816 SF

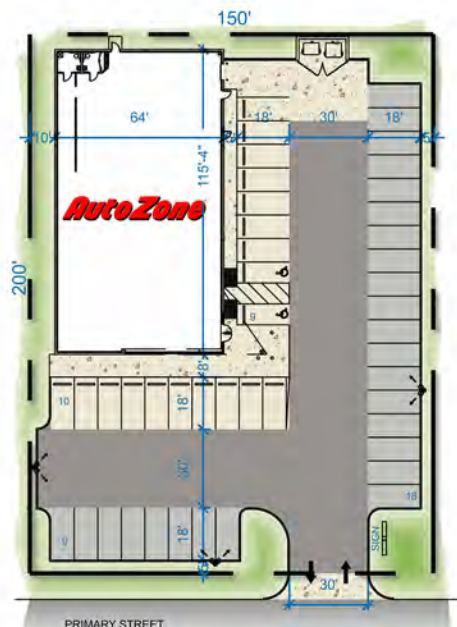

**7N2 Left**

Net: 6,905 SF  
Gross: 7,381 SF

- REGULAR DUTY ASPHALT
- HEAVY DUTY ASPHALT
- REGULAR DUTY CONCRETE
- HEAVY DUTY CONCRETE



**7N2 Right**

Net: 6,905 SF  
Gross: 7,381 SF

## VISIT US ON THE INTERNET

For new store development:  
[www.autozonerealestate.com](http://www.autozonerealestate.com)



For surplus properties:  
[www.autozoneexcessproperty.com](http://www.autozoneexcessproperty.com)



AZO  
LISTED  
NYSE



Member of  
International Council  
of Shopping Centers